

## TOSHIBA Installation Manual

### Carrier Remote sensor

To installation personnel - Electrical work and service

### Model: TCB-TC41LUL

#### Accessory parts

No.	Part Name	Q'ty	No.	Part Name	Q'ty
1	Remote sensor	1	3	Wood screw	2
2	Screw 0.16" x 0.79" (M4 x 20 mm)	2	4	Installation Manual	1

#### Remote sensor installation place requirements

- Do not install the remote sensor in a place where it will be exposed to direct sunlight or outside air (near a window or the like).
- Install the remote sensor at a height of 3'3" to 4'11" (1 m - 1.5 m) from the floor.
- Do not install the remote sensor behind obstacles, where it cannot detect the room temperature.
- Install the remote sensor only in the room to be air-conditioned.
- Install the remote sensor vertically on the wall or the like.
- Do not install the remote sensor in a place where it will be exposed to the direct discharge air from the air conditioner.
- Do not install the remote sensor on a wall whose temperature greatly differs from the room temperature.

#### How to wire the remote sensor

##### ■ Connection diagram

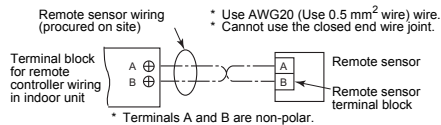

**NOTE 1:** The remote sensor wire should not be bundled with other wires (mains, etc.), or installed with other wires in the same conduit, as malfunction may result.

**NOTE 2:** Install the remote sensor away from sources of electrical interference and electromagnetic fields.

**NOTE 3:** If electrical interference is unavoidable, countermeasures such as appropriate filtering should be employed.

#### How to install the remote sensor

##### ■ Installation procedure

- Insert a flat head screw driver or the like into the slot at the bottom of the remote sensor, and twist it to remove the rear case.
- Secure the rear case on a wall or the like using the supplied wood screws (2 pcs). (Overtightening may damage the rear case or LCD.)
- Wire the remote sensor after checking the connector No. (A, B) of the indoor unit to prevent miswiring. (Applying AC 208/230 V causes damage.)
- Attach the remote sensor to the rear case by fitting its hooks into the slits of the rear case.

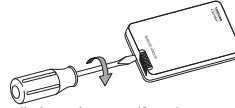

##### ■ Installing the remote sensor on the wall

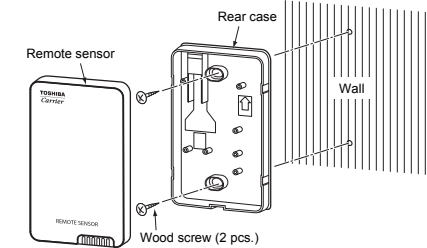

- Cut the wiring parts (shaded) at the top of the remote sensor and rear case using a knife, nipper, or the like.
- Protect the wires with the wire cover.

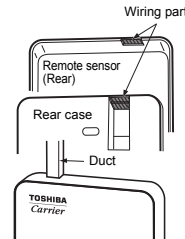

**NOTE 1:** Leave a distance of at least 1.18" (30 mm) around the remote sensor.

#### Combination remote controller installation requirements

##### ■ How to install

- Set the remote controller as the header. (The factory default setting is header.)
- Set the room temperature sensor settings of the remote controller to the factory default settings on the indoor unit side.

##### ■ Basic wiring diagram

- Controlling one indoor unit from a remote sensor and remote controller

